

# General Requirements All Products

## FRAMING

Timber or metal frames should comply with the Building Code of Australia (BCA). Where applicable, timber frames may be in accordance with Australian Standard 1684 - Residential Timber - Framed Construction. Metal frames should be erected in accordance with the manufacturer's recommendations.

Frames should be straight and true with studs at a maximum of 600mm centres.

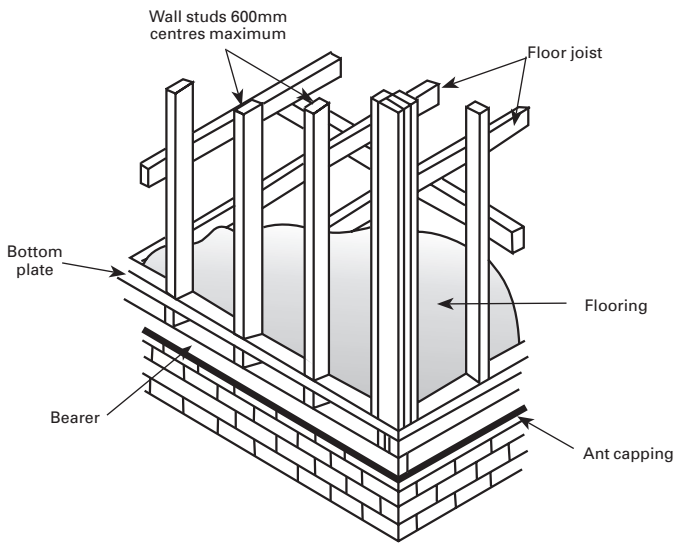

## FLASHING AND WEATHERPROOFING

Before fixing Weathertex®, all wall openings, vertical joints, sills, heads and corners should be weatherproofed with flashing to comply with BCA.

Flash horizontal joints between Weathertex® sheets with galvanised 'Z' section weatherstrip or PVC horizontal joint moulding.

On walls projecting from the roof line in upper storey construction, keep the bottom edge of Weathertex® weatherboards 50mm clear of the lower storey roof claddings. Weatherproof with an approved flashing.

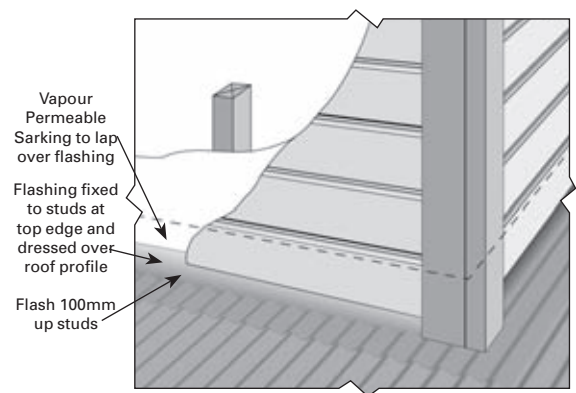

## DAMP-PROOF COURSES (DPC)

Lower framing timbers should be isolated from ground moisture by suitable damp-proof courses or termite shielding. Similarly, Weathertex® Weatherboards or sheets should not be placed in direct contact with masonry, brickwork or concrete. Where necessary use strips of polyethylene to isolate the materials.

Allow at least 150mm clearance between the bottom edge of Weathertex® Weatherboards and paved surfaces which are exposed to the weather and at least 225mm clearance to unprotected ground.

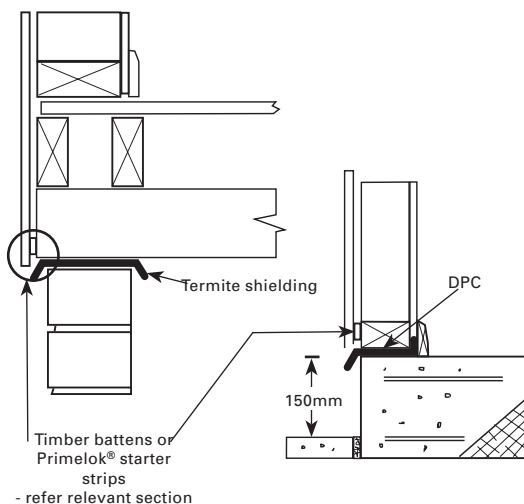

If using a vapour barrier, such as plastic film or aluminium foil, place it on the warm side of the wall frame to avoid condensation within the wall cavity, ie. under internal linings in regions which experience cold temperature conditions. Please obtain specialist advice when locating vapour barriers in buildings in hot or tropical zones or where cooling or humidity control equipment is installed.

**Vapour permeable sarking** such as Bradford Thermofoil™ Breather Foil 799, Bradford Thermotuff™ LD Breather Foil or ACI Sisalation 499 **may be used directly under Weathertex® Weatherboards, especially on walls subject to high wind conditions and wind updraughts.**

## PRIMING

To comply with good building practice timber mouldings, including corner stops and trims, should be primed with exterior, solvent-based or acrylic tannin resistant wood primer before installation.

Also, sawn edges of Weathertex® Weatherboards and sheets which are exposed, butt joined on studs or meet other materials such as timber stops must be primed with solvent-based or acrylic tannin resistant wood primer. A sprayable primer is the most efficient method.

# Cutting and Storage

**Cutting:** Weathertex® products are easy to cut and shape with a normal hand or power saw. Weathertex® may be stacked two or three high for multiple cutting. Primelok® weatherboards should be cut individually to protect the aligning spline. Where required, edges may be trimmed with a smoothing plane or sandpaper. Holes are easily drilled with high speed drills or clean cutter bits.

**Storage:** Weathertex® products should be stored flat, under cover and on timber bearers spaced at maximum centres of 600mm.

**When storing outside, keep the stack clear of the ground and cover with waterproof materials to prevent water staining.**

# Painting and Maintenance

**Paint Colour:** Paint colour can have an effect on the performance of Weathertex® products. Because Weathertex® is a wood product, its dimensions will change in moisture content. **Dark paint colours can allow surfaces in warmer climates to become very hot in direct sunlight (up to 80°C)** leading to loss of moisture and subsequent shrinkage of the weatherboard.

**Plastic joint trimmers can also distort at temperature above 70°C.** Light paint colours will lead to better thermal efficiency of the building and minimise problems due to moisture change.

**Preparation:** Surfaces should be free from dirt, dust or grease. Set fasteners flush with the surface and where necessary fill any holes with proprietary filler. Lightly sandpaper smooth any nibs or blemishes which have occurred during fixing.

**Painting:** The primed surface of Weathertex® weatherboards and architectural panels are suitable for the application of exterior grade 100% acrylic or solvent-based paint systems.

Unprimed products, such as Weathertex® Wall Shingles, should be painted with an exterior 100% acrylic paint which is suitable for direct application to timber. Light colour paints should be tannin blocking. The paint manufacturer's recommendations on paint suitability, mixing and application, should also be followed. For further information on recommended paints contact our customer service hotline on 1800 040 080.\*

**ALWAYS PAINT WEATHERTEX® WEATHERBOARDS, ARCHITECTURAL PANELS AND WEATHERTEX® SHINGLES WITHIN 60 DAYS OF FIXING. FAILURE TO OBSERVE THIS CRITERIA MAY RESULT IN POOR ADHESION OF THE TOP COAT.**

**Acrylic Finishes:** Apply two coats of exterior 100% acrylic paint as specified, direct to the Weathertex® weatherboard surface, and all exposed edges (cut surfaces should be primed as outlined in "Priming").

**Solvent-based Finishes:** Apply one coat of solvent-based undercoat direct to pre-primed Weathertex® weatherboard surfaces. Allow to dry for a minimum of 24-hours. Finish with one or two coats of gloss or semi-gloss exterior solvent-based paint.

**Maintenance:** Regularly wash the paint surface with water to remove dirt and grime and to improve the performance of the coating. Generally, exterior surface coatings deteriorate by chalking rather than flaking. When repainting becomes necessary and the surface is unbroken, wash down with water. Remove all loose chalk, dirt and dust by sandpapering, and dust off. Make good any defects and fill where necessary. Apply a minimum of two coats of paint in accordance with the paint manufacturer's recommendations.

\* Factsheets available

# Health and Safety

The normal health and safety precautions should be taken when working with wood panel products. Machine tools should be fitted with dust extractors and work areas kept clean. If dust levels exceed Worksafe Australia Standards the wearing of a dust mask (AS 1715 and AS 1716) and safety glasses (AS 1337) is recommended. Storage and work areas should be adequately ventilated.

For more information please telephone 1800 040 080 (toll free) for your copy of the Weathertex® Exterior Cladding Material Safety Data Sheet.

# Fact Sheets

Weathertex® has available the following fact sheets and project sheets. For your copy please contact our Customer Service Hotline on 1800 040 080.

**FACT SHEETS:** Weathertex® Exterior Signboard Manual • Weathertex® & Fire • Weathertex® & Termites • Painting & Staining Weathertex® • Weathertex® as Interior Lining • Alternative Installation Methods

**PROJECT SHEETS:** Cubby House • Weathertex® Shingles • Pool Pump

# Technical Information

For further information on Weathertex® physical properties, such as early fire hazard, structural bracing and specific design for high wind areas, please contact our Customer Service Hotline on 1800 040 080.

# Product Information

## PHYSICAL PROPERTIES

The following information is based on data from production and research centres. This information is intended as a guide to the properties of 9.5mm Weathertex® weatherboards and sheets. If more accurate information is required on these or any other properties, please contact Weathertex® Pty Ltd on 1800 040 080.

**Table 4 - Physical Properties**

Property	Unit	Typical Values
Density	kg/m <sup>3</sup>	990
Mass/Unit Area	kg/m <sup>2</sup>	9.4
Modulus of Rupture	MPa	30
Modulus of Elasticity	MPa	4500
Moisture content ex mill	%	7.5
Hygro-Expansivity*	%	0.25
* = change in face dimensions over the range of 50% to 90% relative humidity		

## SOUND TRANSMISSION

A wall consisting of 100mm x 50mm timber studs at 450mm centres, covered with Weathertex® and lined internally with 5.5mm hardboard, was tested at the NATA registered, Building Material Acoustical Laboratory, Concord, NSW – STC 35. The sound transmission class can be increased to around STC 38-40 by using fibreglass or insulating board beneath the internal lining. Further STC data can be obtained in the "Weathertex® and Fire" Factsheet.

## HIGH WIND AREAS

Weathertex® fixing systems have been subject to simulated wind suction forces at the Cyclone Testing Station, James Cook University, Townsville, Queensland, and in our own laboratory.

When fixed as specified to timber studs the Weathertex® profiles are suitable for use as shown in Table 6. Wind classifications are as defined in AS4055-1992 "Wind Loads for Housing" and calculations use a local pressure factor for planks within 1200mm of the building edge.

**Table 6 - High Wind Areas**

Weathertex® Product	Highest Wind Classification				
	Stud Centres (mm)	Regions A & B		Regions C & D	
		Unlined Wall	Internally Lined	Unlined Wall	Internally Lined
<b>Weathertex® Weatherboards</b>					
200mm wide Classic, Rusticated, Millwood and Old Colonial	450	N5	N5	C2	C3
	600	N4	N4	C1	C2
Wall Shingles	450	N5	N5	C2	C3
	600	N2	N2	n/a	n/a
<b>Weathertex Primelok® Weatherboards</b>					
Federation	450	N5	N5	C2	C3
	600	N4	N4	C1	C2
Classic and Braidwood	450	N4	N4	C1	C2
	600	N2	N3	n/a	C1
<b>Weathertex® Sheets</b>					
Smooth, Panelgroove® & Weathergroove® - Joined OFF stud	450	N4	N4	C1	C2
	600	N2	N3	n/a	C1
Smooth, Panelgroove® & Weathergroove® - Joined ON stud	450	N5	N5	C2	C3
	600	N3	N4	n/a	C2

AS4055 -1992 Wind Classification N3 is equivalent to a maximum ultimate limit state design gust wind speed of 50m/s (NZS 3604:1999 classification *very high*). N4 and N5 are equivalent to 61m/s and 74m/s respectively.

## THERMAL INSULATION

The thermal conductivity of Weathertex® weatherboard is 0.195W/mK. The thermal resistance R-value for the 9.5mm thickness is 0.05m<sup>2</sup>K/W.

**ENERGY EFFICIENT HOUSING:** Energy Efficient Housing is an initiative of the Australian Greenhouse Office and has been adopted by most States. House designs are assessed on a "star" rating principle (1 to 5 stars with 5 being the best).

A Weathertex® clad timber frame, internally lined and with various levels of insulation within the cavity will contribute to the achievement of energy efficiency. The thermal insulation values achieved are shown in Table 5.

**Table 5 - Thermal Insulation**

Insulation within wall framing cavity	R-value of Total Wall (m2K/W)
Nil	0.4
Double sided perforated reflective foil laminate (rfl) dished between studs	1.3
R1.5 bulk insulation between studs with breathable foil or building paper under Weathertex®	1.7
R1.8 bulk insulation between studs with breathable foil or building paper under Weathertex®	1.9